

## DS-6101HFI-SATA Digital Video Server

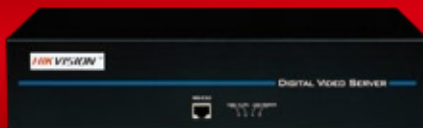

### Key Features

- High performance DSP hardware compression
- H.264 video compression
- Dual streams
- Support variable bit rate and frame rate
- Multi-zone motion detection and private masking
- Multi-lever user access management

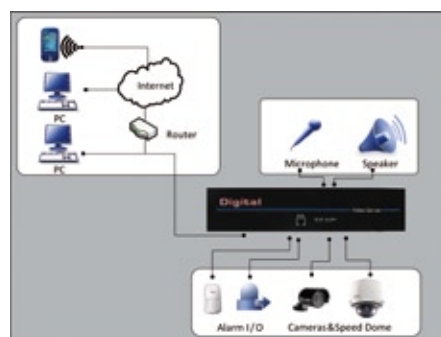

### Specifications

		DS-6101HFI-SATA
Video/Audio input	Video compression	H.264
	Video input	1-ch
	Video input interface	BNC (1.0Vp-p, 75Ω), PAL/NTSC
	Audio compression	OggVorbis, 16Kbps
	Audio input	1-ch
	Audio input interface	BNC (2.0Vp-p, 1kΩ)
Video/Audio output	Voice talk input	1 channel RCA (2.0Vp-p, 1kΩ)
	Recording resolution	4CIF/DCIF/2CIF/CIF/QCIF
	Frame rate	4CIF: 25fps(PAL) / 30fps(NTSC)
	Stream type	Video / Video & Audio
	Support dual stream	Yes
	Video bit rate	32Kbps ~ 2Mbps, or user-defined (Max. 8Mbps)
External interface	Audio output	1 channel RCA(Linear electrical level, 600Ω)
	Communication interface	1 RJ45 10M/100M adaptive Ethernet interface, 1 RS232 interface, 1 RJ45 interface, and 1 RS485 interface
	SATA interface	1 interface for 1 SATA hard disk, the max capacity is 2000GB
	Alarm input	4-ch
General	Alarm output	2-ch
	Power supply	110-240VAC, 47~63Hz
	Consumption	≤40W (without HDD)
	Working temperature	-10°C~+55°C(14°F~131°F)
	Working humidity	10%~90%
	Dimension	225(D)x78(H)x350mm(W)(8.87"(D)x3.07"(H)x13.79"(W))
Weight(without HDD)	≤3500g(7.72lbs)	