



IndigoVision



# Bullet Cameras

High-end: performance, not price tag.

With BX HD and 4MP Bullet Cameras you get supreme connectivity and flexibility, combined with great video and audio. You also get maximum reliability, and the other significant benefits of IndigoVision's Distributed Network Architecture. BX HD and 4MP Bullet Cameras deliver a different dimension of safety when combined with IndigoVision's Control Center.

## Key Features

SENSOR	<b>HD</b>	<b>4MP</b>	<b>Day/Night</b>	<b>WDR</b>
	COMPRESSION	<b>H.264</b>	<b>UP TO 30fps</b>	<b>G.711</b>
		INTELLIGENCE	<b>Analytics</b>	<b>Motion Detection</b>
	OTHER		<b>DNA</b>	<b>PoE</b>
PHYSICAL		<b>Outdoor</b>	<b>IR</b>	<b>IK10</b>

## Product Codes

Bullet Camera	Camera
HD Bullet Camera	610660
4MP Bullet Camera	611660

Product Code 66xxxx also available to order consisting of 61xxxx Product Code plus Enhanced Management Software License.

## Dimensions - Bullet Camera

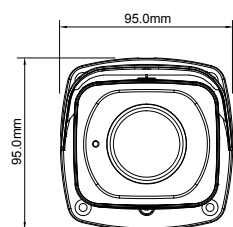

View on Front Face

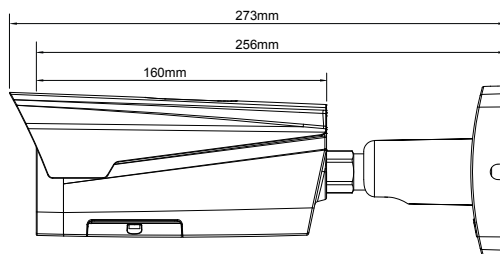

View on Side Face

## Dimensions - Mounting Hole Pattern

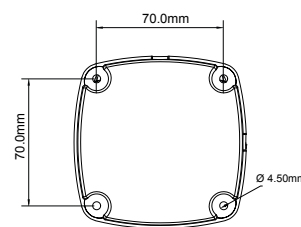

View on Front Face

## Specification

Camera Features	HD	4MP
Sensor	1/3" Progressive CMOS	1/3" Progressive CMOS
Active Pixels	HD (1920x1080)	4 MP (2560x1440)
Horizontal Resolution	> 800 TVL	> 1000 TVL
Minimum Sensitivity	Day: 0.1 Lux (colour). Night: 0.01 Lux (mono). 30 IRE, F1.4, 1/30s shutter	Day: 0.1 Lux (colour). Night: 0.01 Lux (mono). 30 IRE, F1.4, 1/15s shutter
Dynamic Range	WDR > 120dB	
Gain Control	Auto/Manual setting	
Back Light Compensation	On/Off	
White Balance Mode	Auto/Manual	
Day/Night	True Day/Night with Mechanical IR Cut Filter	
IR Illuminator	Built-in IR Illuminator 850nm wavelength, effective distance >50m	
Video Resolution	2560x1440 pixels (4MP)*; 2304x1296 pixels (3MP)*; 1920x1080 pixels (HD); 1280x960 pixels (1.3MP); 1280x720 pixels (720p); 704x576 pixels (D1); 704x480 pixels (D1) 352x288 pixels (SIF); 352x240 pixels (SIF)	
Signal/Noise Level	> 50dB	
Lens Options	2.7mm - 12mm, Horizontal view angle 100° (W) 33° (T), F1.4, Vari-focal, M14 mount with Remote Zoom/Focus	
Shutter	Rolling; Auto from 1/3 - 1/10,000 sec	
Exposure Control	Auto/Low Noise/Low Motion Blur/Manual	
Video Compression	Full frame rate, full colour: H.264/MJPEG ; up to 30fps (ISO 14496-10)	
Privacy Zones	4 User Defined	
Video Bit Rate	User-configurable bit rates from 64Kbps up to 10Mbps	
Video Multi-Streaming	Up to 32Mbps total video output; Unlimited multicast connections; Up to four 8Mbps unicast connections	
Video Multi-Encoder	Up to two simultaneous resolutions including: 4MP (20fps)*, 3MP (30fps)*, 1080p (30fps), 720p (30fps), D1 (30fps), SIF (30fps)	
Video Analytics	Motion Detection, Hooded, Tripwire, Intrusion, Abandoned, Missing	
Audio Compression	G.711	
Audio Bit Rate	32Kbps per channel	
Audio Resolution	Full Duplex, 8kHz or 16kHz sample rate. Mono Input, Mono Output	
Audio Analytics	Audio Detection	
Audio Input	Line in, RCA connector	
Audio Output	Line out, RCA connector	
Binary Input/Output	2 Pull up inputs for non powered contacts; 1 Solid state open collector output, Max 5.0V, 30mA	
Network Interface	IEEE802.3 and IETF standards: 10/100 Base-T Ethernet, IPv4/IPv6, TCP, UDP, RTP, RTSP, ICMP, IGMP, SNMP, HTTP, HTTPS, SSH, PPPoE, uPnP, QoS, DHCP	
Network Security	HTTPS, IP Filter, IEEE 802.1x	
Time	Embedded real-time clock, NTP client	
SD Storage	microSDHC 128GB support (card not included)**	
Dimension/Weight	94.92mm (h) x 94.92mm (w) x 272.90mm (l) and 1.1Kg (with sun shade)	
Regulatory	EN 55022 Class A, EN 61000-3-2, EN 61000-3-3, FCC Part 15 Subpart B Class A, EN 50130-4, EN61000-4-2, EN61000-4-3, EN61000-4-4, EN61000-4-5, EN61000-4-6, EN61000-4-11, IEC60068-2-27 (Shock), IEC60068-2-6 (Sine Vibration), UL60950	
Housing	White vandal resistant aluminium alloy with polycarbonate sun shade including 200mm cable bundle	
Protection Rating	IP67, IK10 (IEC 62262)	
Electrical	Camera only: PoE (802.3af Class 0) or 12V DC @ 0.33A; 4W. Camera including heater: PoE (802.3af Class 0) or 12V DC @ 1.0A; 12W. Power supply ordered separately (Product code: 110064; 130176)	
Operating Temperature	-40°C to 60°C	
Cold Start	-30°C	
IndigoVision Software Requirements	Control Center v13.2 or later	
ONVIF	Profile S	

\* 4MP and 3MP resolution only available on 4MP variant. \*\* SDCard Storage independent of IndigoVision's NVRs.