

CCTV LENS SPEC

Model NO.	TV0309D-IR		Specification	Vari-focal DC Auto Iris IR ASPHERICAL	
Focallength	3-9mm		Mount	CS-Mount	
F number	F1.2-C		Flange Back Length	13.6mm	
Max. Image format	Φ6.0mm (1/3")		M. O. D	0.2m	
Control	Iris	DC Driver		Dimension	Φ33*45.8
	Focus	Manual		Weight	45g
	Zoom	Manual		Operating Temperature	-10~50°C
Field of View	D	1/3"	138° ~39.5°	1/4"	90.3° ~29.3°
	H		111° ~31.6°		69.6° ~23.4°
	V		83° ~23.7°		50.8° ~17.4°

Dimension

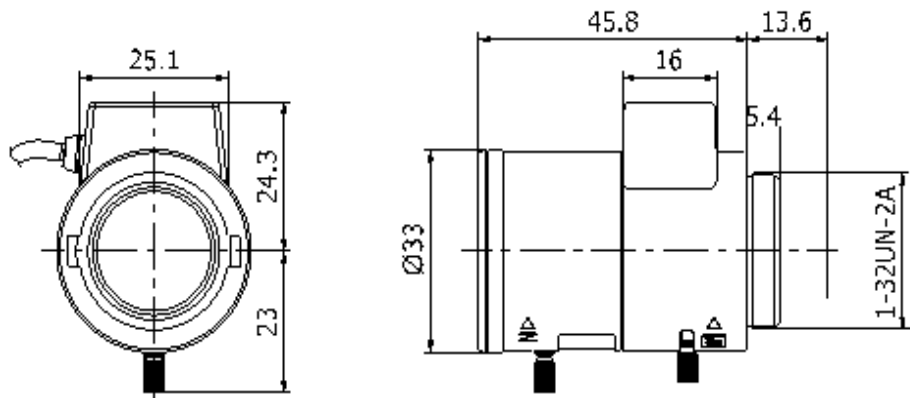

Unit: mm

Lens Picture

